

**Cara's Barn**

**Groundfloor** - Accessed from either the cobbled yard or The Orchard Room you will find the fully fitted commercial kitchen and past the reception area at the bottom of the stairs the toilets, including disabled toilets. The reception can be used as the bar area with the doors opening out onto the cobbled yard.

**Upstairs** (approx 17' x 33') - Stairs lead up to the mezzanine dining area seating up to 60 guests comfortably at round tables. Floor to ceiling windows overlooking the cobbled yard with the twin glass double doors offering stunning views out over the Wiltshire countryside. This together with the oak beamed vaulted ceiling brings a true atmosphere to your special occasion.

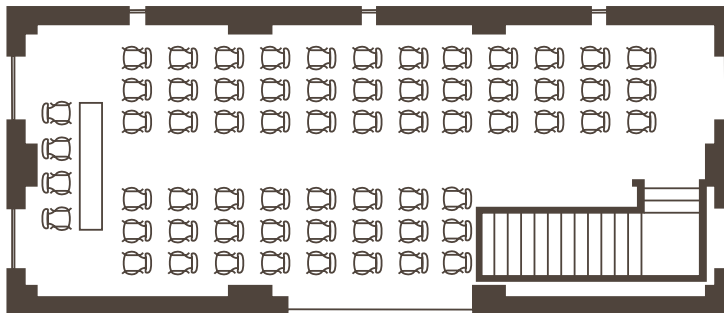
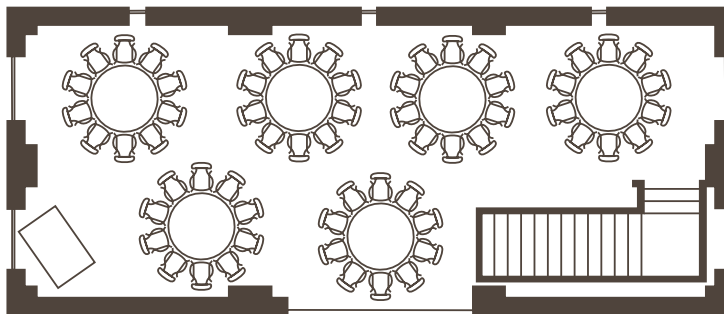

Cara's Barn: Diagrams showing examples of seating plans in the upstairs function room

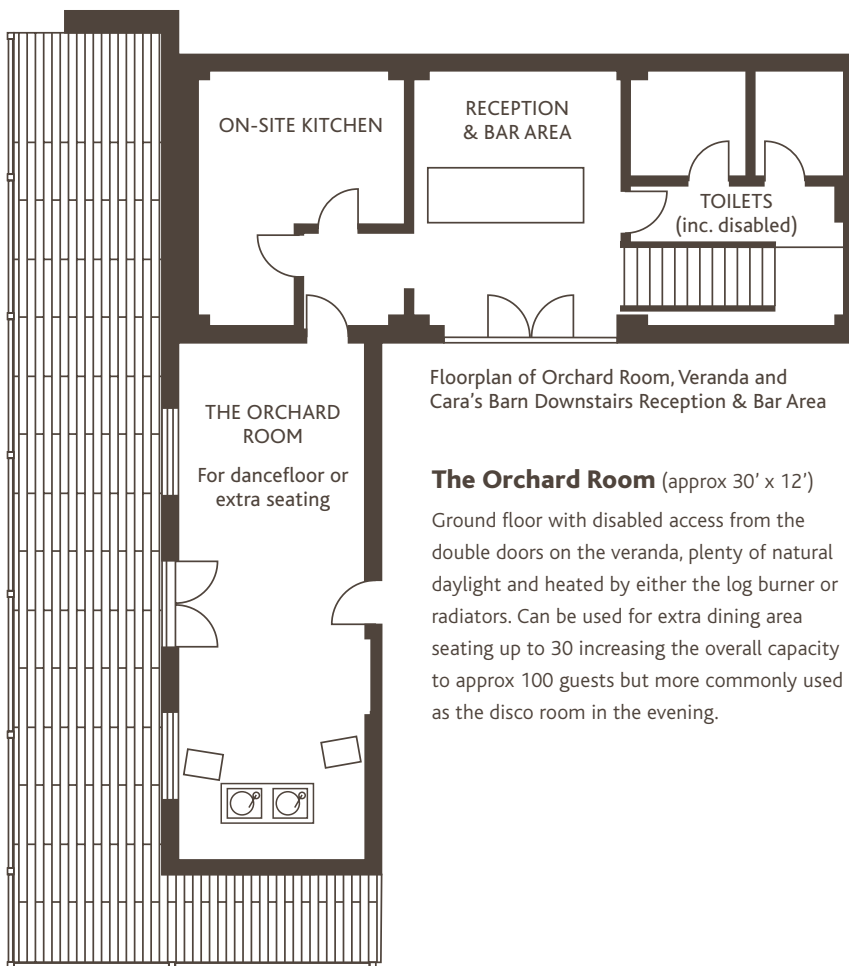

Floorplan of Orchard Room, Veranda and Cara's Barn Downstairs Reception & Bar Area

**The Orchard Room** (approx 30' x 12')

Ground floor with disabled access from the double doors on the veranda, plenty of natural daylight and heated by either the log burner or radiators. Can be used for extra dining area seating up to 30 increasing the overall capacity to approx 100 guests but more commonly used as the disco room in the evening.

